



**Noorjax Consulting**

**Pharmaceutical Lab Expansion  
Amid Uncertainty of Future  
Processes**



## About Us

Noorjax Consulting develops simulation models using mostly AnyLogic for companies and governments worldwide.

We also have a simulation modeling school with 15 different courses.

<https://www.noorjax.com>



# What Is The Project

One of the big pharma companies produces patches in a laboratory

- They produce thousands of these products on a yearly basis
- They want to scale the production to 10x
- Same facility, different technology
- Disagreement within the company

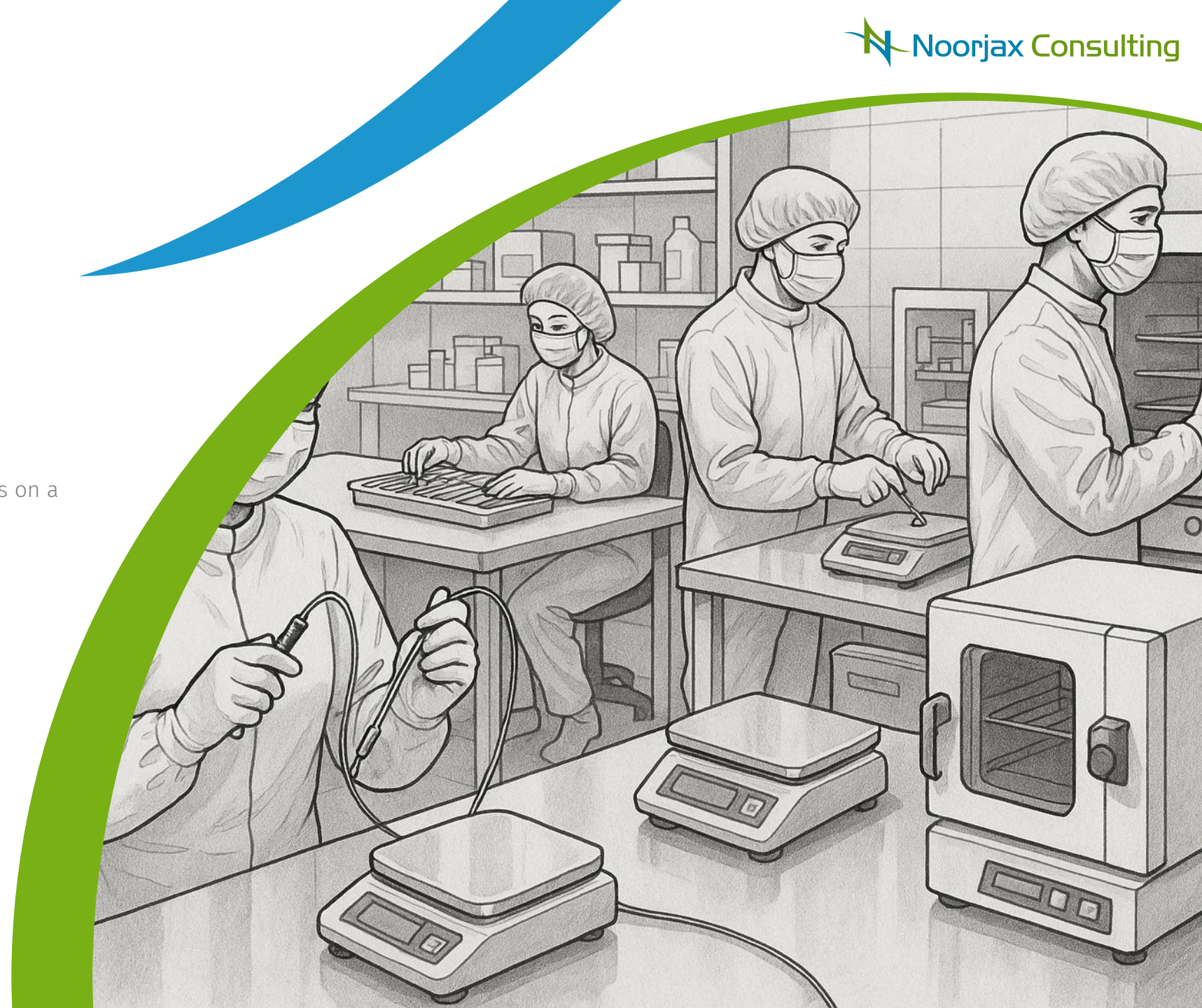



# Why is this Interesting

Unknown future process  
Needs quick results



## Current Process Validation

Basics: build the model, validate it



## Unknown future Operations

They are still working on a future technology that can take multiple shapes



## Work Fast

Unknown model must be functional in an impossibly short time



## Maximum Flexibility

What to do?

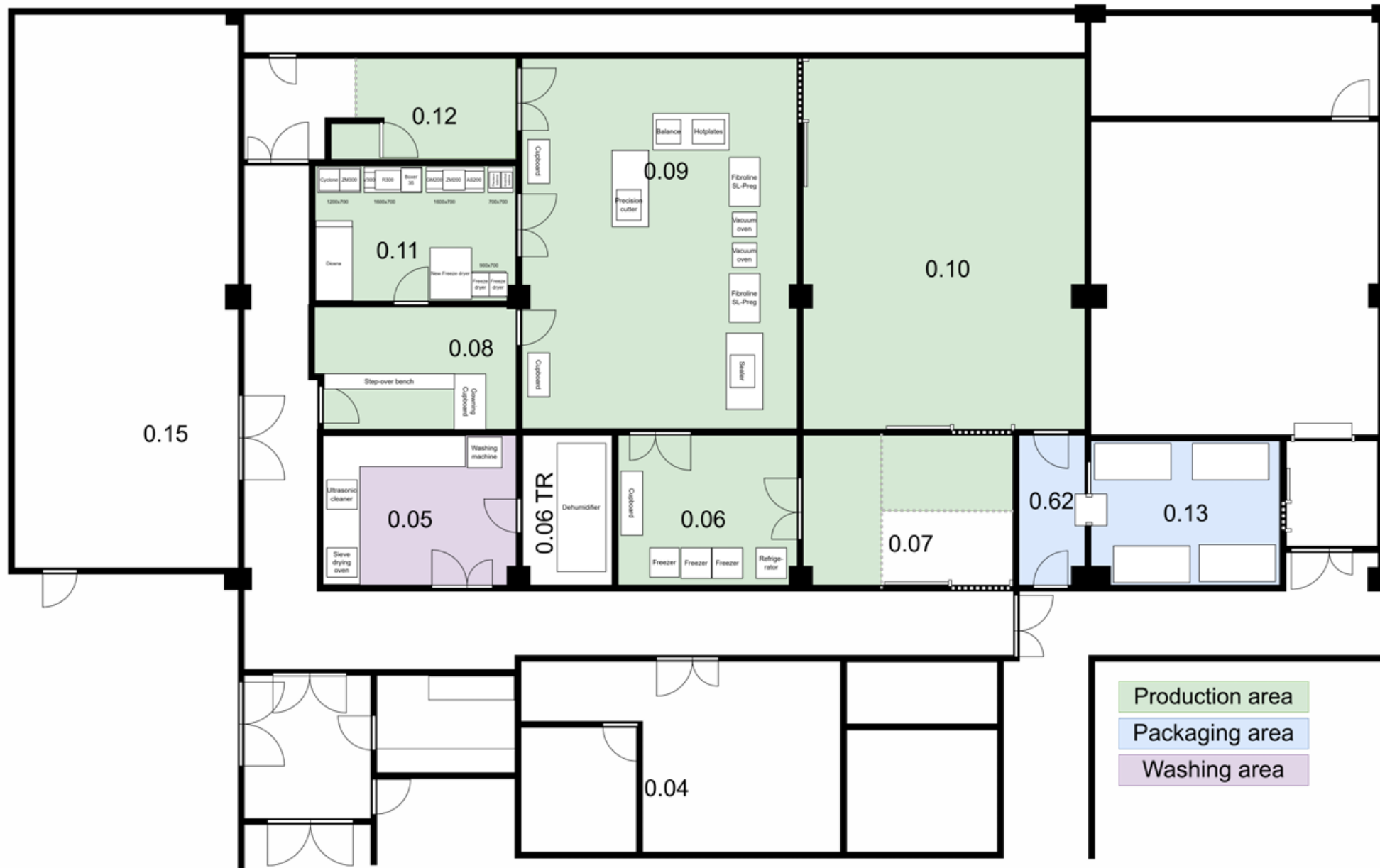

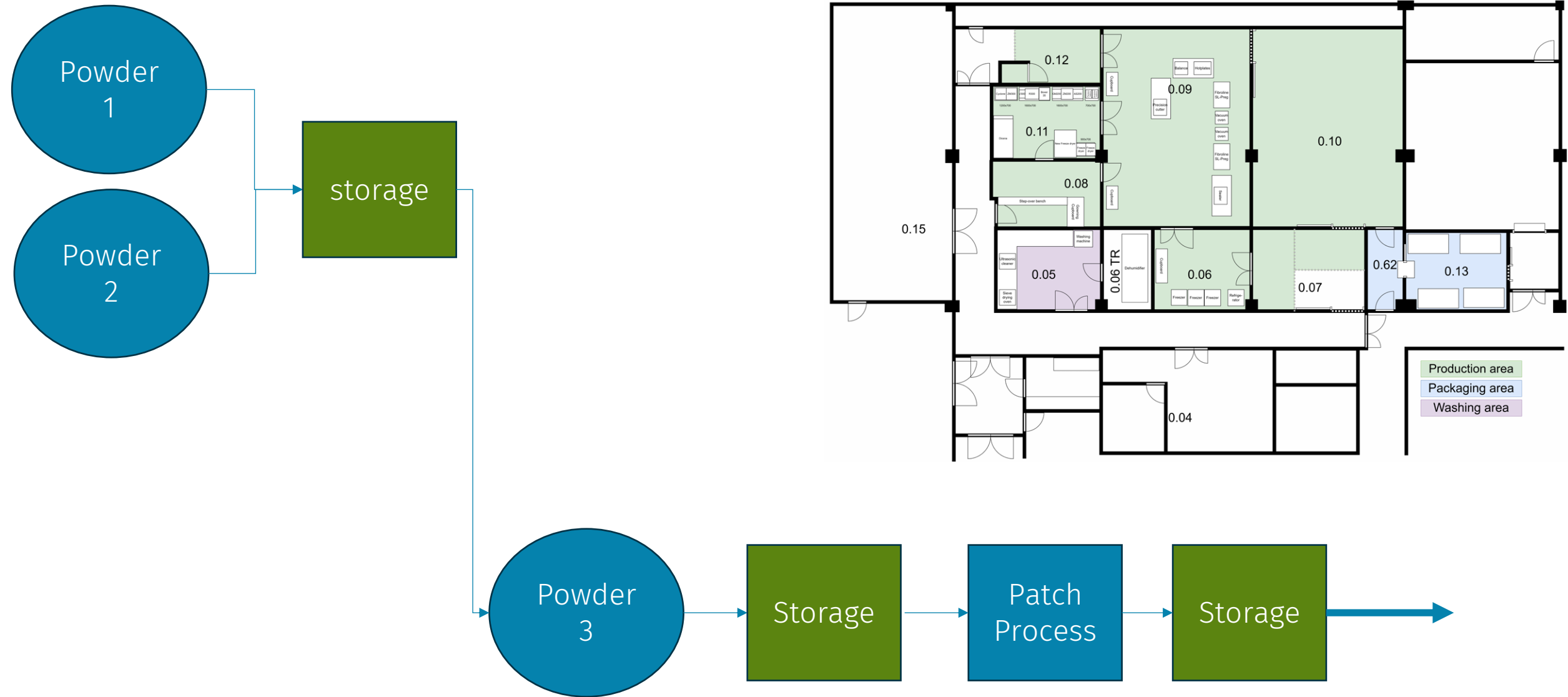

# How to develop it



## Build the Processes

### Classic Discrete Events

Easy to read the simulation,  
easier and faster to build,  
difficult to change



## Full Recipe

### Processes defined in Excel

Absolute flexibility,  
complicated user interface,  
classes hold process  
information



## Partial Recipe

### Limited Processes in Excel

High flexibility, more control,  
easier to read

## Classic Discrete Events – Worst Case Scenario

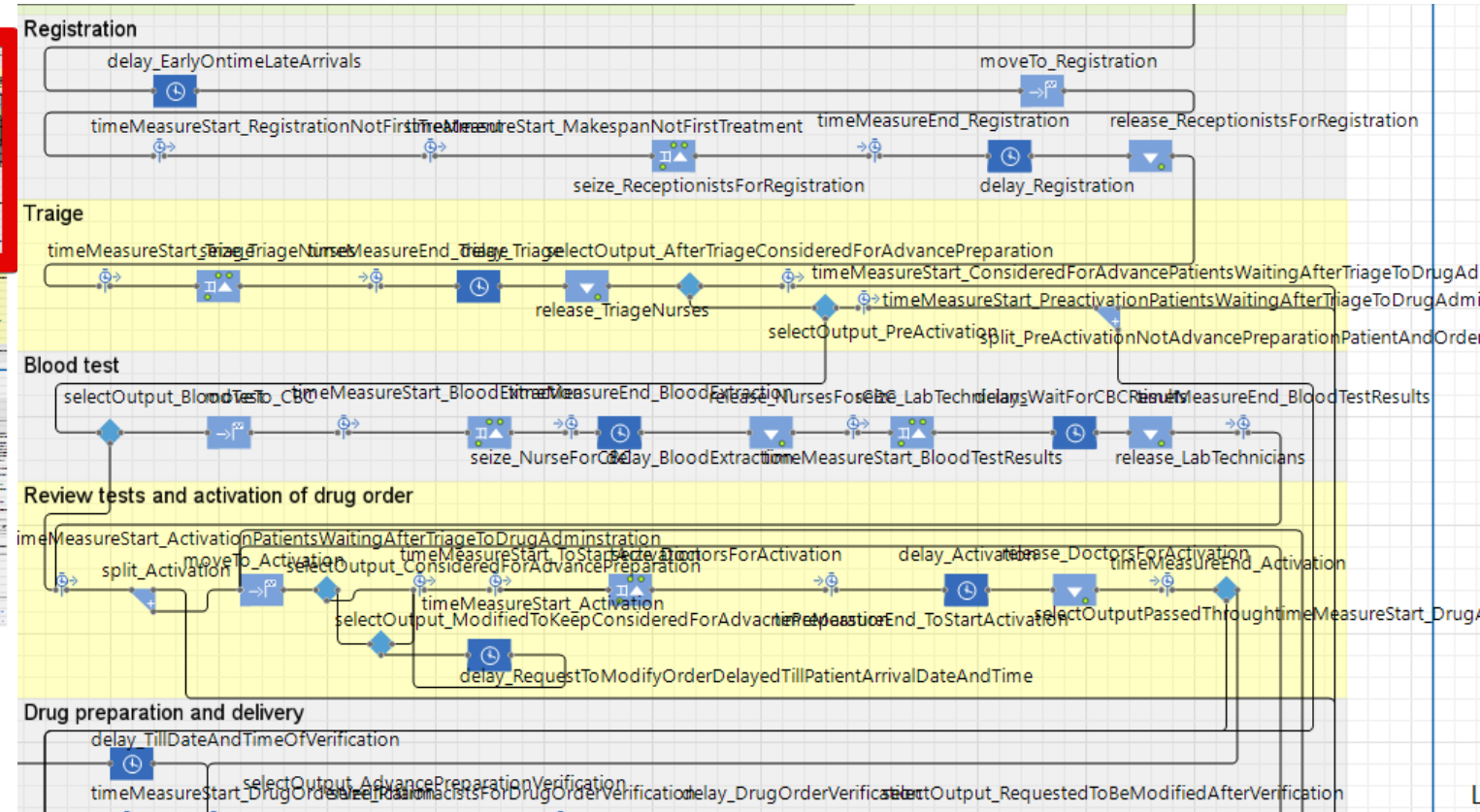
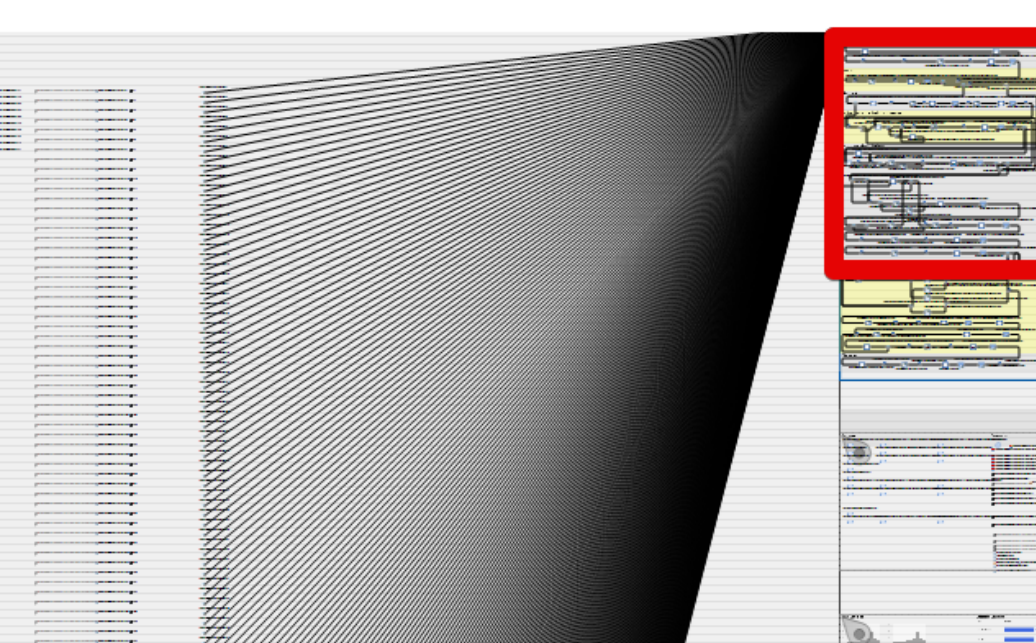



## Full Recipe – Worst Case Scenario

id	Name	Time in minutes	Seize resources id normal	Release resources	Number of predecessor	Condition normal	True normal	False normal	True subprocess	Seize resources	Release resources	Number of predecessor	Condition preactivation	True preactivation	False preactivation	True subprocess preactivation	Seize resource	Release resources	Number of predecessor	Condition advancePrep	True advanc	False advanc	True subprocess
0	Dummy				0		{2}					0		{2}					0		1		{DrugBatch_13}
1	Time between advance prep	time between advance prep and arrival																	1		2		
2	Arrival				1		{3}					0		3					1		3		
3	Registration	weibull(1.42, 4.01, 0.90)	6	6	1		{4}			{6}	6	1		4			6	6	1		4		
4	Triage	weibull(1.42, 4.47321, -0.42438)	7	7	1		{5}			7	7	1		20		{DrugBatch_17}	7	7	1		20		
5	Decide blood test same day	0			1	blood same day?	{7}	{6}															
6	Blood test day before	0			1	has drugs?		{20}	{DrugBatch_9}														
7	Blood test same day	triangular(2, 7, 4)	5	5	1		{8}																
8	Wait for results	triangular(5, 51, 11)	8	8	1	has drugs?		{20}	{DrugBatch_9}														
20	Seize bed	0	{9}		1	has drugs?	21	26		{9}		1		21			{9}		1		21		
21	Premedication	weibull(1.32, 1.2)	{5}	5	1		22			{5}	5	2		22			{5}	5	2		22		
22	After premedication	triangular( 3, 15, 8)			1		23					1		23					1		23		
23	Drug injection	normal(2.13,2.92)	5	5	1		24			5	5	1		24			5	5	1		24		
24	Administer drugs	administration_time_in_hours			1	more drugs?	23	25				1	more drugs?	23	25				1	more drugs?	23	25	
25	Drug removal	beta(0.67, 0.577, 0, 3.43)	5	5	1		26			5	5	1		26			5	5	1		26		
26	Check patient health	lognormal(3.72197, 0.89038, -2.70147)			1		27					1		27					1		27		
27	Patient is discharged	weibull(1.42, 4.01, 0.90)	5	{5,9}	1					5	{5,9}	1					5	{5,9}	1				

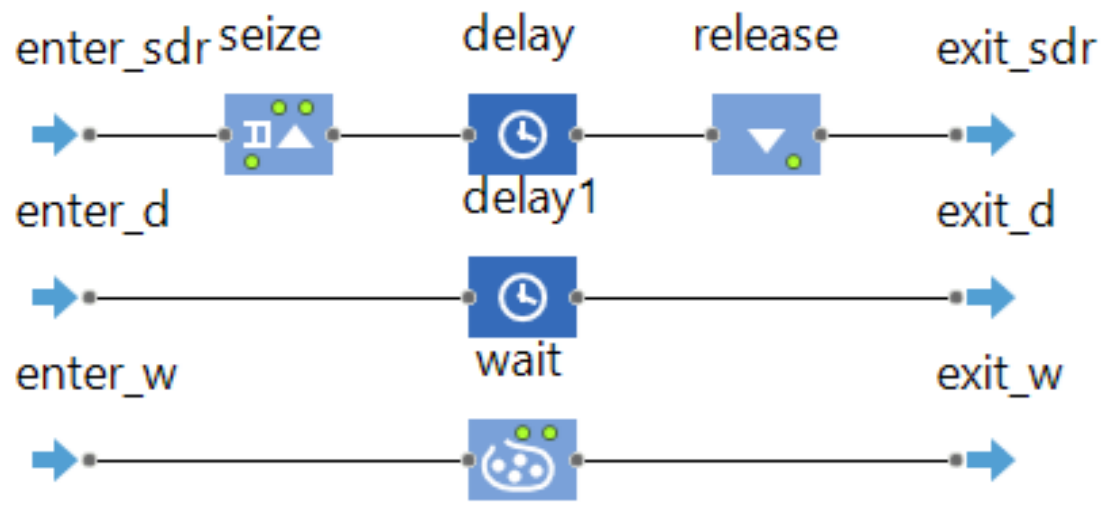

# Operation Components

A room has:

- Equipment that stays in room
- Utensils that need washing

A room Process Requires

- Paperwork before, after and during process
- Safety protocols
- Raw Material
- Operators with knowledge on the process



	A	B	C	D	E
	name	code	washable by hand	time to wash unit by hand (minutes)	fraction of washing machine used
1					
2	Round bottom flasks	rbf	FALSE	20	5%
3	Splash heads	sh	FALSE	20	5%
4	Erlenmeyer	er	FALSE	20	5%

## Partial Recipe – Our Preferred Methodology

Process	step	setup (minutes)	number of cycles	cycle process (minutes)	materials in	equipment
ELPOX	blue coloration	uniform(120,180)	12	uniform(20,25)	{"elp":500.0,"wfi":1000.0,"dye":250.0,"wb":10.0}	{"ab":1,"pb":1,"km":1,"rv":2,"tm":2}
ELPOX	lyophilization	uniform(0,0)	1	3600	{}	{"fd":6,"dsp":6}
ELPOX	milling	uniform(30,45)	12	uniform(2,3)	{}	{"pb":1,"km":1}
ELPOX	drying1	uniform(0,0)	1	960	{}	{"rv":2}
ELPOX	fine milling	uniform(60,80)	3	uniform(10,12)	{}	{"ucm":1,"pb":1}
ELPOX	sieving	uniform(0,0)	4.5	uniform(10,12)	{}	{"ss":1,"pb":1}
ELPOX	drying2	uniform(0,0)	1	960	{}	{"rv":2}
ELPOX	packaging	uniform(30,40)	110	uniform(1,2)	{"lb":50.0,"po":50.0}	{"pb":1,"ab":1}
ELPOX	storage	uniform(0,0)	1	uniform(1,2)	{}	{}
NUPOX	milling	uniforr				
NUPOX	drying1	uniforr				

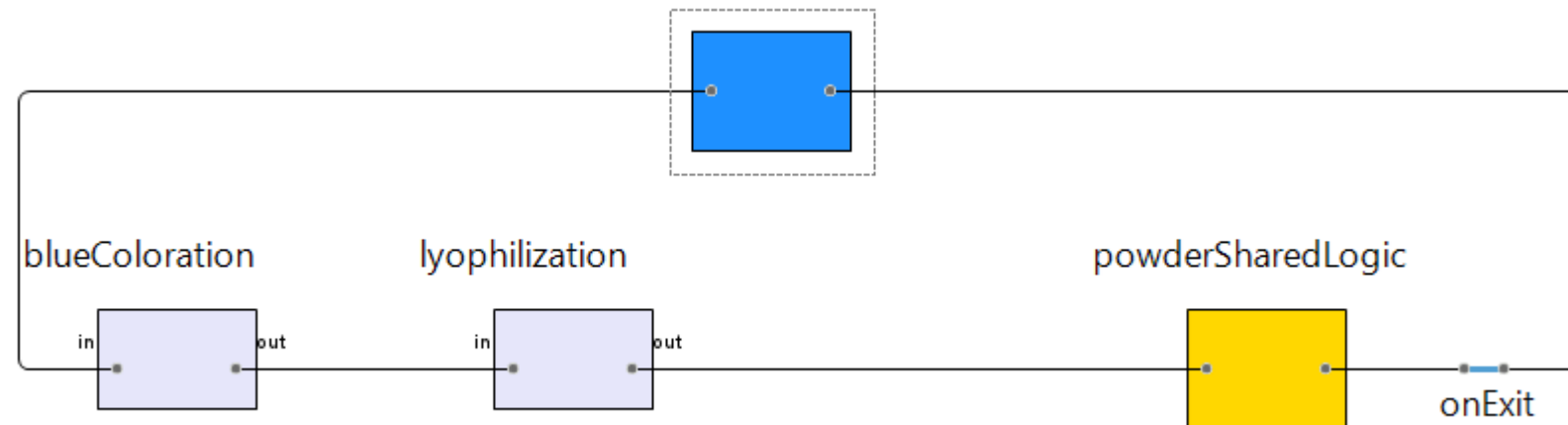

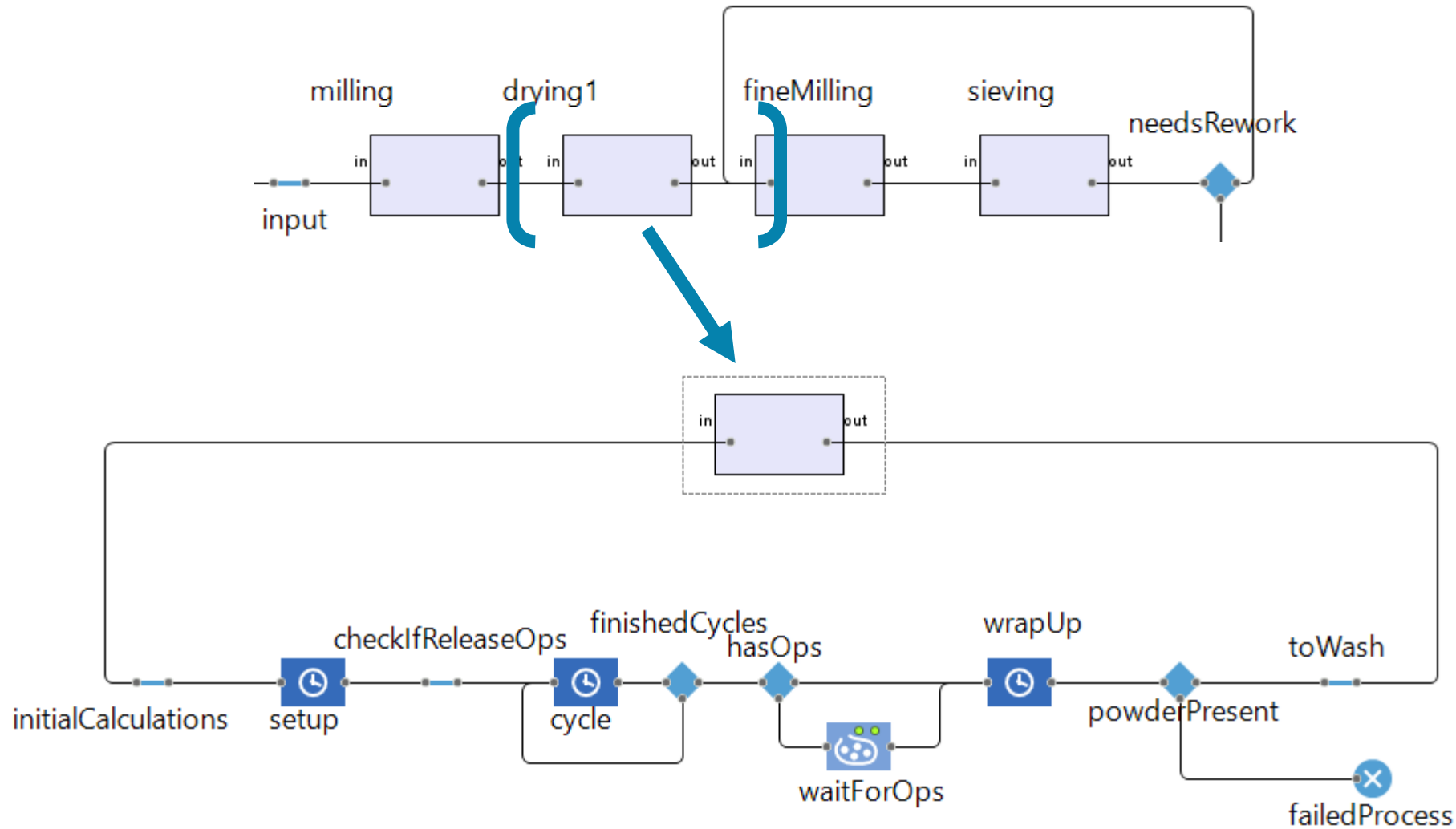





## Results

- They generated 100s of scenarios
- Exported information was used to report
- Scenarios
  - What to do with current equipment
  - What to do in the short term
  - How to transition technology
  - What to do in the long term

### Accumulated Patches Over Time

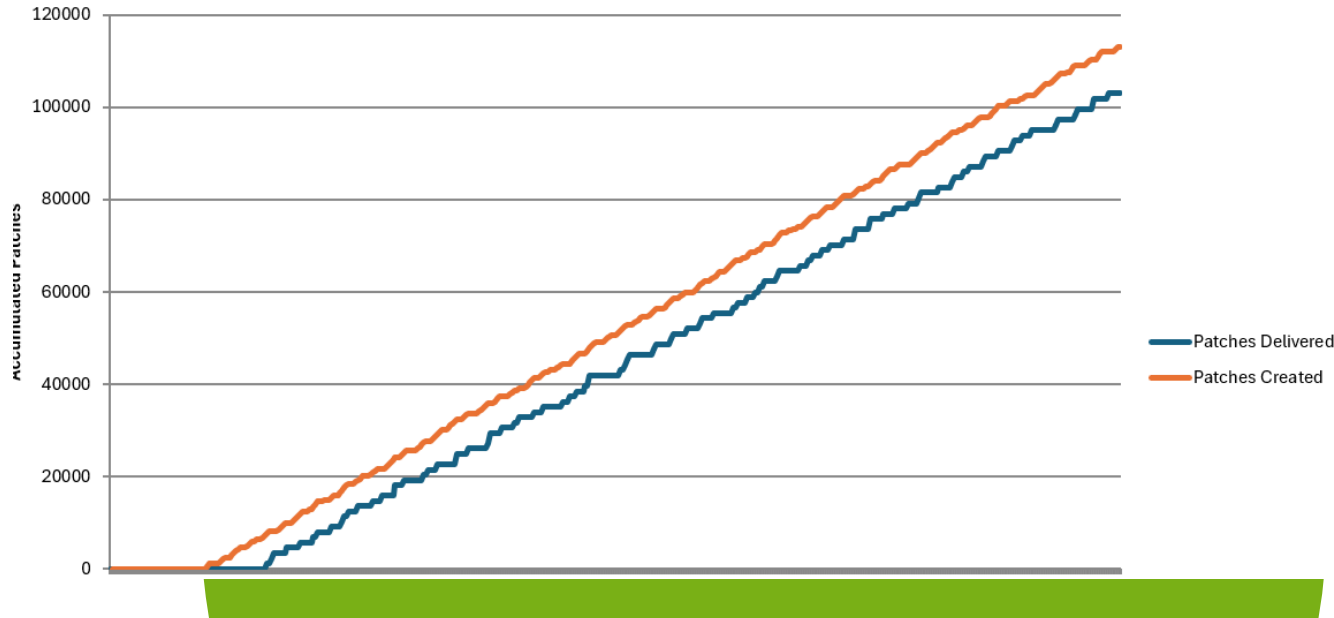

### Daily Storage Amounts (g) by Material & QC Status

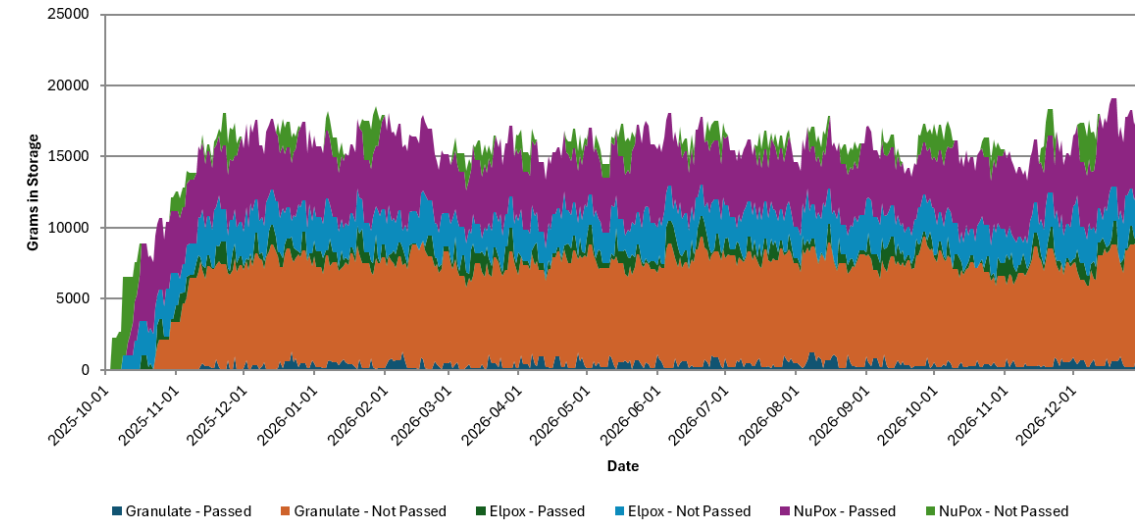

### Daily QA Entries per Process

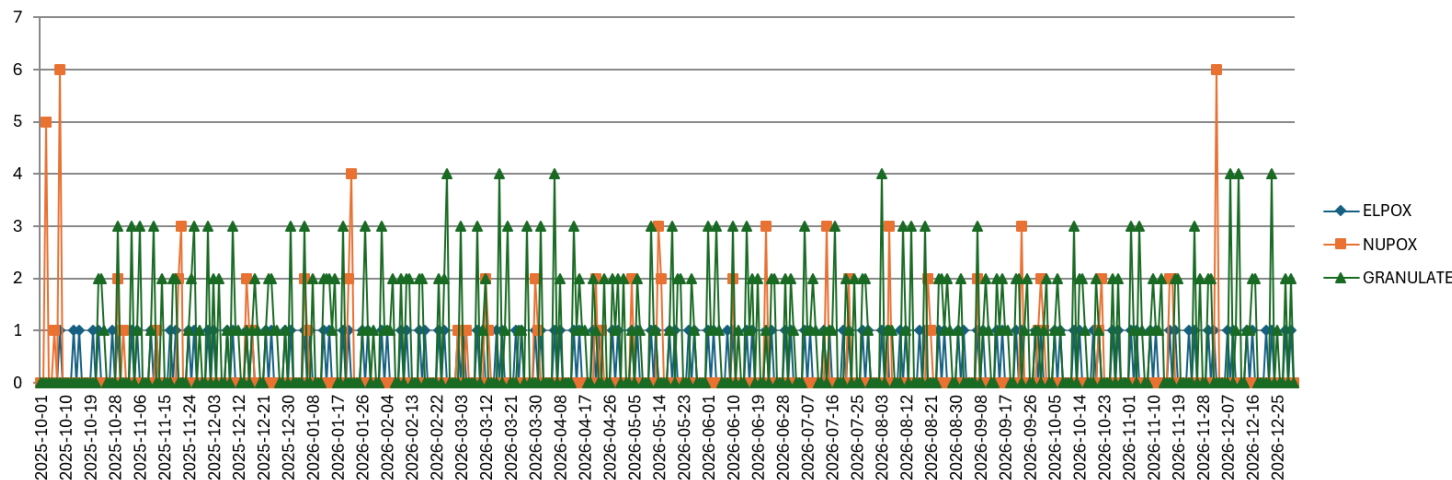

## Other Data

- Utilization of Resources
- Flow of Utensils
- Utilization of Equipment
- Raw Material Requirements
- Storage Requirements
- Washing Room Utilization

12/2/2026 7:00	12/2/2026 8:00	12/2/2026 9:00	12/2/2026 10:00	12/2/2026 11:00	12/2/2026 12:00	12/2/2026 13:00	12/2/2026 14:00	12/2/2026 15:00
off	PATCHPOSTDRYING	PATCHPOSTDRYING	idle	idle	idle	idle	idle	off
off	PATCHPOSTDRYING	PATCHPOSTDRYING	idle	idle	idle	idle	idle	off
off	PATCHPOSTDRYING	PATCHPOSTDRYING	PATCHPOSTDRYING	PATCHPOSTDRYING	idle	idle	idle	off
off	PATCHPOSTDRYING	PATCHPOSTDRYING	PATCHPOSTDRYING	PATCHPOSTDRYING	idle	idle	idle	off
off	PATCHPOSTDRYING	PATCHPOSTDRYING	PATCHPOSTDRYING	PATCHPOSTDRYING	idle	idle	idle	off
off	PATCHPOSTDRYING	PATCHPOSTDRYING	PATCHPOSTDRYING	PATCHPOSTDRYING	idle	idle	idle	off
off	PATCHPOSTDRYING	PATCHPOSTDRYING	PATCHPOSTDRYING	PATCHPOSTDRYING	idle	idle	idle	off
off	PATCHPOSTDRYING	PATCHPOSTDRYING	PATCHPOSTDRYING	idle	idle	idle	idle	off
off	PATCHPOSTDRYING	PATCHPOSTDRYING	PATCHPOSTDRYING	NUPOX	NUPOX	idle	idle	off
off	ELPOX	ELPOX	ELPOX	ELPOX	idle	idle	idle	off
off	ELPOX	ELPOX	ELPOX	ELPOX	idle	idle	idle	off
off	NUPOX	NUPOX	NUPOX	NUPOX	NUPOX	idle	idle	off
off	NUPOX	NUPOX	NUPOX	idle	NUPOX	NUPOX	NUPOX	off
off	NUPOX	NUPOX	idle	PATCHNORMAL	PATCHNORMAL	idle	idle	off
off	NUPOX	NUPOX	idle	PATCHNORMAL	PATCHNORMAL	NUPOX	NUPOX	NUPOX
off	idle	idle	PACKAGING	PACKAGING	PACKAGING	PACKAGING	idle	off
off	idle	idle	PACKAGING	PACKAGING	PACKAGING	PACKAGING	idle	off
off	idle	idle	NUPOX	NUPOX	NUPOX	NUPOX	NUPOX	off
off	idle	idle	NUPOX	NUPOX	idle	NUPOX	NUPOX	NUPOX
12/9/2026 7:00	12/9/2026 8:00	12/9/2026 9:00	12/9/2026 10:00	12/9/2026 11:00	12/9/2026 12:00	12/9/2026 13:00	12/9/2026 14:00	12/9/2026 15:00
off	GRANULATE	GRANULATE	idle	idle	idle	idle	idle	off
off	GRANULATE	GRANULATE	idle	idle	idle	idle	idle	off
off	ELPOX	ELPOX	ELPOX	ELPOX	idle	idle	idle	off
off	ELPOX	ELPOX	ELPOX	ELPOX	idle	idle	idle	off
off	GRANULATE	GRANULATE	GRANULATE	GRANULATE	idle	idle	idle	off
off	GRANULATE	GRANULATE	GRANULATE	GRANULATE	idle	GRANULATE	GRANULATE	GRANULATE
off	idle	idle	idle	idle	GRANULATE	GRANULATE	GRANULATE	off
off	idle	idle	idle	idle	GRANULATE	GRANULATE	GRANULATE	off
off	idle	idle	idle	PATCHPOSTDRYING	PATCHPOSTDRYING	PATCHPOSTDRYING	PATCHPOSTDRYING	off
off	idle	idle	idle	PATCHPOSTDRYING	PATCHPOSTDRYING	PATCHPOSTDRYING	PATCHPOSTDRYING	off
off	idle	idle	idle	PATCHPOSTDRYING	PATCHPOSTDRYING	PATCHPOSTDRYING	idle	off
off	idle	idle	idle	PATCHPOSTDRYING	PATCHPOSTDRYING	PATCHPOSTDRYING	idle	off
off	idle	idle	idle	PATCHPOSTDRYING	PATCHPOSTDRYING	PATCHPOSTDRYING	PATCHPOSTDRYING	off
off	idle	idle	idle	PATCHPOSTDRYING	PATCHPOSTDRYING	PATCHPOSTDRYING	PATCHPOSTDRYING	off
off	idle	idle	idle	PATCHPOSTDRYING	PATCHPOSTDRYING	PATCHPOSTDRYING	PATCHPOSTDRYING	off
off	idle	idle	idle	PATCHPOSTDRYING	PATCHPOSTDRYING	PATCHPOSTDRYING	PATCHPOSTDRYING	off
off	idle	idle	GRANULATE	GRANULATE	GRANULATE	GRANULATE	GRANULATE	GRANULATE
off	idle	idle	GRANULATE	GRANULATE	GRANULATE	idle	idle	off

# Conclusions



How flexible is the model

## **Flexibility Performance**

They were able to generate all scenarios with minimal interaction with us



What did they get from it

## **Is the Model Useful**

Created a comprehensive report with short- and long-term plans, working with the Engineers to implement new technologies and test the effects



# EXPERT

New Technology

## **Future Work**

There is more to do and there might be a phase 2 when there's better understanding on the technology that can be used.





## Information

# Contact information

 Ahtri 12, Tallinn, Estonia

 +372 5810 5330

 [info@noorjax.com](mailto:info@noorjax.com)

 [www.Noorjax.com](http://www.Noorjax.com)

 @Noorjax

 @Noorjax Consulting